

AGU Glass Tube Fuse

- Normal Blow Glass Tube Fuses
- 10.3ø x 38.1mm (13/32 x 1-1/2 Inch)
- Caps: Brass With Gold Plating
- Body: Glass Tube
- Element: Zinc Alloy
- Standards: UL & CSA 248-14
- Ampere Rating: 10-80A
- Voltage Rating: 32V
- No Fuse Holders Available for AGU Fuses

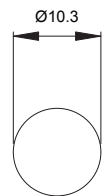
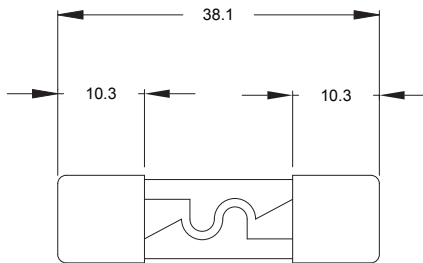

Scale: mm

Specifications

Opening Time / Pre-arcing Time:

In	1.0 In	1.35 In	2.0 In
10-80A	> 4 Hours	Max.	Max.
		1 Hour	30 s

Ordering Information:

Part No.	Ampere (A)	Voltage (VDC)
AGU-10	10 A	32 V
AGU-15	15 A	32 V
AGU-20	20 A	32 V
AGU-25	25 A	32 V
AGU-30	30 A	32 V
AGU-35	35 A	32 V
AGU-40	40 A	32 V
AGU-45	45 A	32 V
AGU-50	50 A	32 V
AGU-60	60 A	32 V
AGU-70	70 A	32 V
AGU-80	80 A	32 V